

# PHOLA

The modular spiral staircase which combines the warmth of solid wood with the strength of steel, offering a variety of combinations of diameters and finishes.





## MATERIALS AND COLORS

### STEPS

- Solid beech wood, 40 mm thickness
  - No knots or splits, maximum stability and mechanical strength thanks to Finger Joint technology
  - Non-toxic water-based coating; 3 layers of paint
- ### HANDRAIL
- In plastic material matching the color of the structure

### Wood colors (steps)

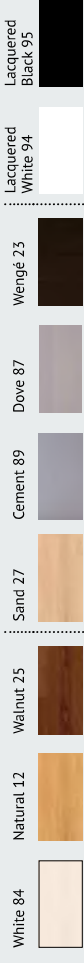

### Steel colors (structure and railing)



### STRUCTURE

- Steel modular elements
- Powder coated with matt scratch proof finish

### RAILING

- Painted steel vertical rails matching the color of the structure

## MEASUREMENTS valid for all the configurations

The **SYSTEM FOR ADJUSTING THE HEIGHT BETWEEN THE STEPS (RISE)** allows you to:

- Obtain different heights between floors with the same number of steps.
- Obtain the height between the floors as required with more or fewer steps (this means you can find the best compromise between the step height and the space occupied by the staircase).

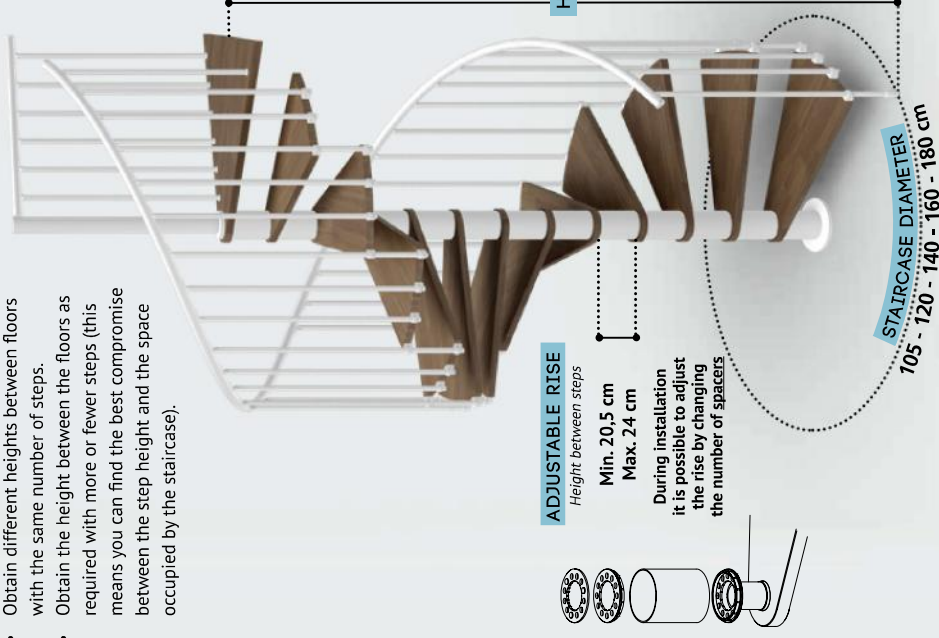

NUMBER OF STEPS	HEIGHT BETWEEN FLOORS (H)
10 steps 1 box	Min. 205 cm Max. 240 cm
11 steps 1 box	Min. 226 cm Max. 264 cm
12 steps 1 box	Min. 246 cm Max. 288 cm
13 steps 1 box	Min. 267 cm Max. 312 cm
14 steps 1 box+1 extra step	Min. 287 cm Max. 336 cm
15 steps 1 box+2 extra steps	Min. 308 cm Max. 360 cm
16 steps 1 box+3 extra steps	Min. 328 cm Max. 384 cm

10 steps  
1 box

11 steps  
1 box

12 steps  
1 box

13 steps  
1 box

14 steps  
1 box+1 extra step

15 steps  
1 box+2 extra steps

16 steps  
1 box+3 extra steps

Add more steps to reach greater heights.

- H = Finished floor to finished floor height.
- Top universal landing fixed at the same level as the finished upper floor.
- Ceiling opening diameter: staircase diameter + 5 cm.

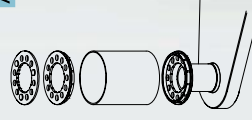

## CONFIGURATIONS

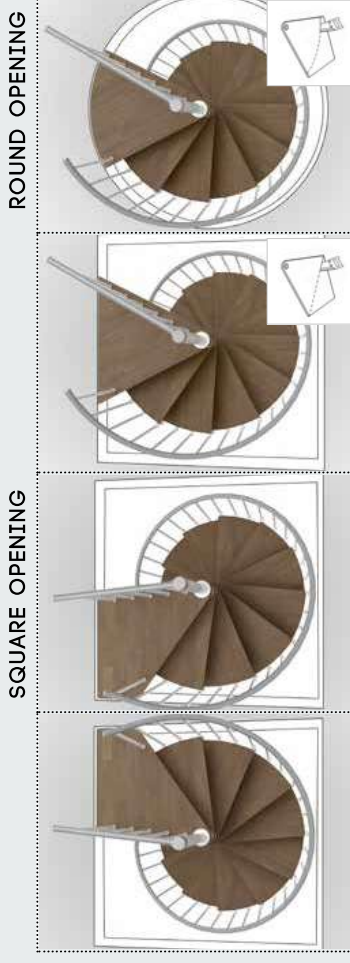

UNIVERSAL LANDING WITH 60° OPENING: adaptable to any opening during installation

## PACKAGE

**1 box = 1 complete staircase of 13 steps (landing included)**

Structure, steps, railing, handrail

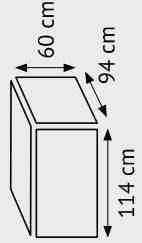

The measures of the box may vary

### DIRECTION OF ASCENT

Clockwise Counter clockwise



### ACCESSORIES

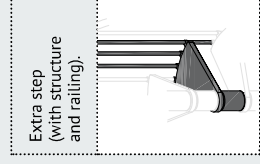

Extra step (with structure and railing).

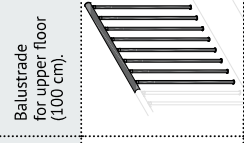

Wooden handrail (not available for the diam. 105 cm)

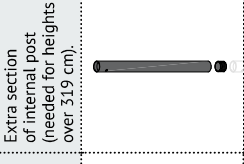

Balustrade for upper floor (100 cm).

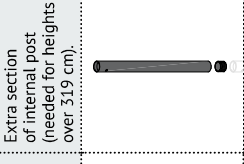

Extra section of internal post (needed for heights over 3,19 cm).